

HEAVY DUTY



FLAT BED SOLUTIONS

Corner Protectors

X-TREME Guard® | 12" - 48" Plastic

- Constructed of high density polyethylene for strength and durability
- Spreads the strap tension over the length of the guard
- More durable than wood and greater memory than aluminum

| Part Number | Trade Size (Inches) |
|-------------|---------------------|
| 50089-12 | 12" |
| 50089-24 | 24" |
| 50089-39 | 39" |
| 50089-48 | 48" |

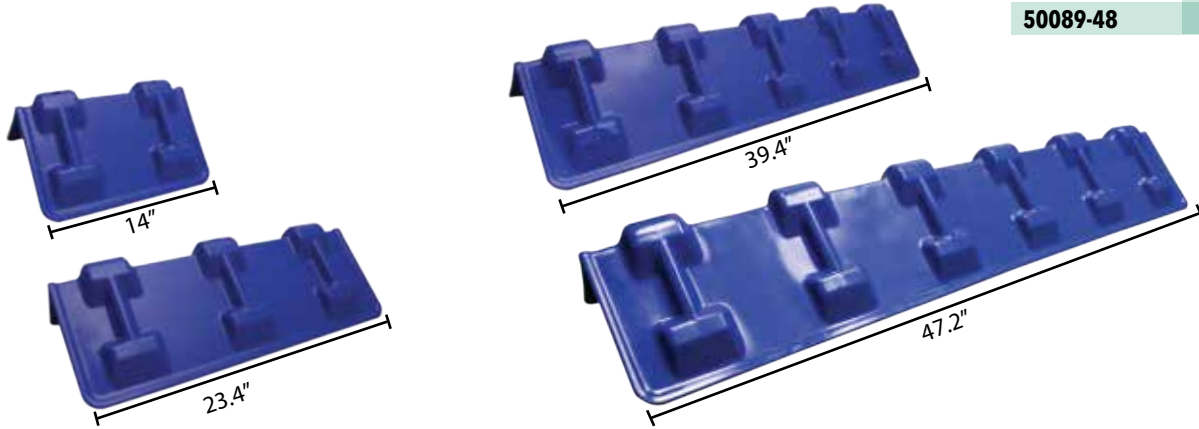

42098-12 | Rubber Sleeve

- Extends 5" to protect the load
- For webbing up to 4" wide



49377-11 | 4" Rubber Coated Steel

- For use with chain
- Extends 4" to protect load



50451-21 | Corner Protector Placement Tool

- Lightweight, telescoping tool extends 4' to 8'
- Powder-coated steel handle
- Designed specifically to work with Ancra Extreme Guard corner protectors
- Works well with most other Ancra corner protectors



49584-10 | 12" HD Plastic

- Extends approx. 3" to protect the load
- Takes up to 4" webbing
- Weather resistant, good to -20°F



43986-10 | 4" HD Plastic

- Takes up to 4" webbing
- High density polymer
- Bulk packaged with UPC



41516-11 | 4" Aluminum

- For 2" webbing



49377-10 | 4" Zinc Plated Steel

- For use with chain
- Extends 4" to protect load



49577-10 | 4" Chain Plate

- Steel (Galvanized)
- For use with chain
- 4" wide and extends 3" on top and 3.5" on bottom to protect the load



49756-10 | 4" Steel

- For use with chain
- Up to 4" winch straps and extends 3-5/8" to protect the load



49913-10 | Tarp Protector

- Yellow plastic



FLAT BED SOLUTIONS

Winch Straps

Webbing Types

Standard High Capacity Webbing (SHC)



- Latex coated polyester with excellent UV protection and abrasion resistance

X-TREME™ High Capacity Webbing



- Polyester webbing with superior weave pattern and permanent proprietary coating that provides twice the abrasion resistance of standard high capacity webbing and greater resistance to damaging water absorption

End Hardware



Chain End



Delta Ring



Flat Hook



Grab Hook



Sewn Loop



Wire Hook

2" STRAPS - SHC

3,333 lbs WLL (1,515 kg)

- Bulk packaged
- Retail pack quantity 1
- Tri-lingual warning tags



| Part Number | Length (Feet) | Hook Type |
|-------------|---------------|------------|
| 41659-10-27 | 27' | Flat |
| 41659-11-27 | 27' | Delta Ring |
| 41659-13-27 | 27' | Wire Hook |
| 41659-10-30 | 30' | Flat |
| 41659-11-30 | 30' | Delta Ring |
| 41659-13-30 | 30' | Wire Hook |

3" STRAPS - SHC

5,400 lbs WLL (2,450 kg)

- Bulk packaged
- Retail pack quantity 1
- Tri-lingual warning tags



| Part Number | Length (Feet) | Hook Type |
|-------------|---------------|-----------|
| 41660-10-27 | 27' | Flat |
| 41660-10-30 | 30' | Flat |
| 41660-18-30 | 30' | Wire Hook |

4" STRAPS - SHC

5,400 lbs WLL (2,450 kg)

- Bulk packaged
- Retail pack quantity 1
- Tri-lingual warning tags



4" FLAT HOOK

| Part Number | Length (Feet) | Hook Type | Webbing Type |
|-------------|---------------|-----------|--------------|
| 43795-10-27 | 27' | Flat | SHC |
| 43795-10-30 | 30' | Flat | SHC |
| 43795-10-35 | 35' | Flat | SHC |
| 43795-10-40 | 40' | Flat | SHC |
| 43795-10-50 | 50' | Flat | SHC |
| 43795-10-60 | 60' | Flat | SHC |

4" DELTA RING

| Part Number | Length (Feet) | Hook Type | Webbing Type |
|-------------|---------------|------------|--------------|
| 43795-11-27 | 27' | Delta Ring | SHC |
| 43795-11-30 | 30' | Delta Ring | SHC |
| 43795-11-35 | 35' | Delta Ring | SHC |
| 43795-11-40 | 40' | Delta Ring | SHC |
| 43795-11-50 | 50' | Delta Ring | SHC |

4" GRAB HOOK

| Part Number | Length (Feet) | Hook Type | Webbing Type |
|-------------|---------------|-----------|--------------|
| 43795-14-27 | 27' | Grab Hook | SHC |
| 43795-14-30 | 30' | Grab Hook | SHC |

4" CHAIN ANCHOR

| Part Number | Length (Feet) | Hook Type | Webbing Type |
|-------------|---------------|--------------|--------------|
| 43795-15-27 | 27' | Chain Anchor | SHC |
| 43795-15-30 | 30' | Chain Anchor | SHC |
| 43795-15-40 | 40' | Chain Anchor | SHC |

4" SEWN LOOP

| Part Number | Length (Feet) | Hook Type | Webbing Type |
|-------------|---------------|-----------|--------------|
| 43795-13-30 | 30' | Sewn Loop | SHC |
| 43795-13-45 | 45' | Sewn Loop | SHC |
| 43795-13-65 | 65' | Sewn Loop | SHC |
| 43795-13-75 | 75' | Sewn Loop | SHC |

4" SPECIALTY

| Part Number | Length (Feet) | Hook Type | Webbing Type |
|-------------|---------------|---------------|--------------|
| 43795-19-30 | 30' | None | SHC |
| 43795-40-30 | 30' | Flat | SHC - Blue |
| 43795-60-30 | 30' | Flat | SHC - Red |
| 214-30KP | 30' | Flat w/Keeper | SHC |



FLAT BED SOLUTIONS

X-Treme™ Winch Straps

- Bulk packaged
- Retail pack quantity 1
- Tri-lingual warning tags



Chain End



Delta Ring



Flat Hook



Grab Hook



Sewn Loop



Wire Hook

2" Straps - X-Treme

| Part Number | Length (Feet) | Width (Inches) | Working Load Limit (lbs) | Hook Type |
|-------------|---------------|----------------|--------------------------|--------------|
| 41659-90-27 | 27' | 2" | 3,333 | Flat |
| 41659-90-30 | 30' | 2" | 3,333 | Flat |
| 41659-92-30 | 30' | 2" | 3,333 | Wire Hook |
| 41659-93-30 | 30' | 2" | 3,333 | Chain Anchor |
| 41659-94-30 | 30' | 2" | 3,333 | None |



4" Straps - X-Treme

| Part Number | Length (Feet) | Width (Inches) | Working Load Limit (lbs) | Hook Type |
|-------------|---------------|----------------|--------------------------|--------------|
| 43795-90-27 | 27' | 4" | 5,400 | Flat |
| 43795-91-27 | 27' | 4" | 5,400 | Delta Ring |
| 43795-90-30 | 30' | 4" | 5,400 | Flat |
| 43795-91-30 | 30' | 4" | 5,400 | Delta Ring |
| 43795-92-30 | 30' | 4" | 5,400 | Sewn Loop |
| 43795-93-30 | 30' | 4" | 5,400 | Sewn Loop |
| 43795-95-30 | 30' | 4" | 5,400 | Chain Anchor |
| 43795-90-40 | 40' | 4" | 5,400 | Flat |
| 43795-91-40 | 40' | 4" | 5,400 | Delta Ring |

4" x 5' Roll-on / Roll-off Container Straps

5,400 lbs WLL (2,450 kg)

| Part Number | End Type | Webbing Type |
|-------------|----------|--------------|
| 49526-10 | N/A | SHC |
| 49526-11 | Loop | SHC |
| 49526-90 | N/A | X-Treme |
| 49526-91 | Loop | X-Treme |



Loop End

Winch Strap Accessories

50092-10 | EZ Winder

- Quickly and easily winds straps onto winches for storage when not in use
- Carded package of 1
- Tri-lingual warning tags

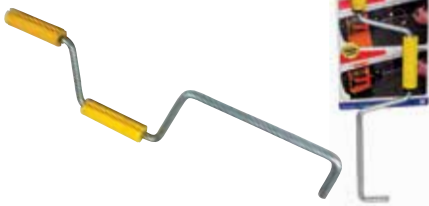

45801-10 | Web Winder

- Quickly and easily wind 2", 3" & 4" straps for compact storage
- All steel construction
- Clamps to vehicle rails



50391-10 | Deluxe Web Winder

- Quickly and easily wind 2", 3" & 4" straps for compact storage
- Premium zinc-plated steel construction
- Clips into stake pockets or onto side rails



50409-10-1PK | TOSS 'N TIE™ Tie-Down Placement Tool

EASY TO USE

- 1) Unroll cord & attach to a cargo strap or cargo chain
- 2) Toss the TOSS 'N TIE ball up & over load
- 3) Go to other side, grab cord & pull your tie-down into place



50433-10 | Winch Strap Storage Band

- Keeps stored straps from unrolling
- 1" By 7" long
- Made of natural rubber
- Pack of 5



40985-05-12 - 12" 40985-05-RL - 100 yd roll Web Protector

- Cordura nylon sleeve
- For 2" webbing



ANATOMY OF A WINCH STRAP

Overall Length

The overall distance from the tip of the attachment hardware (flat hook pictured) to the end of the webbing. Standard lengths are 27' and 30', with the most popular being 30'.



Hardware End

Webbing

Width

Determined by the width of the webbing used, 2", 3" or 4"



Label

Sewn near the hook end is our new extremely durable, yellow reinforced label with proper warnings, usage and working load limits in pounds and kilos.

THE IMPORTANCE OF SECURING CARGO

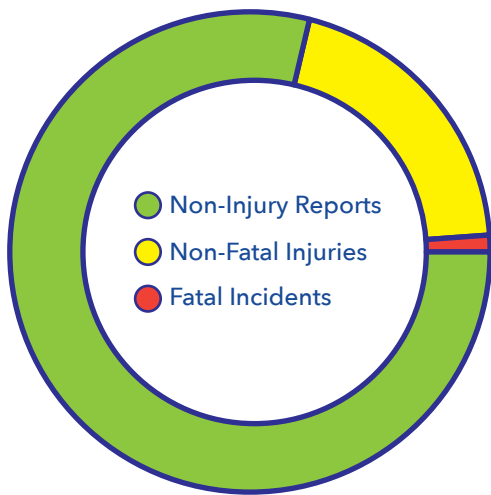

ROAD DEBRIS

ACCIDENT FATALITIES & INJURIES

From 2011 - 2014 there were more than 200,000 police-reported crashes that listed Road Debris as a factor. This resulted in approximately 39,000 involved injuries and 500 deaths.

$20 \text{ lbs} + 55 \text{ mph} = 1,000 \text{ lbs}$

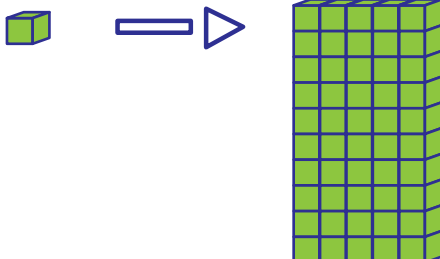

UNSECURED LOAD

STATE FINES & PENALTIES

All 50 U.S. States, plus the District of Columbia, have fines ranging from \$10-\$5,000 for loads that are not properly secure. At least 16 states also add possible imprisonment.



FORCE OF IMPACT

STATIONARY VS MOVING

A 20-pound object traveling at 55 mph hits with the force of 1,000 pounds at the time of impact.

Information from the AAA Foundation.

FLAT BED SOLUTIONS

Winches

Ankra winches comply with DOT, WSTDA-T3 and Canadian Standard 905 regulations. Available in different base configurations to suit a variety of needs and load requirements.

All winches shown are right hand models. Left hand models may be available on special orders.

- Powder coating withstands 250 hours of standard salt spray testing to ensure years of service
- Stamped working load limit and Ankra name certify quality
- High-strength alloy pawl pins
- Seamless solid steel mandrel
- Smooth ground web slots prevent web wear

Low Profile - for clearance issues

Standard - Holds 30' of webbing

Storable - Holds up to 40' of webbing

Portable - Repositionable on track or with bolts

7MM - Heat treated 7MM frame reduces average weight per winch by 2 lbs improving fuel economy & payload capacity

| Part Number | Winch Type | Surface Treatment | Working Load Limit (lbs) | Attachment | Mount Placement |
|--------------|-------------|-------------------|--------------------------|------------|-----------------|
| 43488-20 | Web/Cable | Black Lacquer | 5,500 | Weld-On | Side Frame |
| 43563-10 | Standard | Black Lacquer | 5,500 | Weld-On | Bottom |
| 43564-127 | Portable | Black Powder Coat | 5,500 | Bolt-On | Side Frame |
| 43564-147 | Portable | Black Powder Coat | 5,500 | Bolt-On | Side Frame |
| 43564-167 | Portable | Black Powder Coat | 5,500 | Bolt-On | Side Frame |
| 43565-14 | Storable | Black Powder Coat | 6,000 | Slider | C-Track |
| 43565-127 | Storable | Black Powder Coat | 6,000 | Slider | C-Track |
| 43565-127-XZ | Storable | X-treme Zinc | 6,000 | Slider | C-Track |
| 43565-137 | Standard | Black Powder Coat | 6,000 | Slider | C-Track |
| 43565-157 | Standard | Black Powder Coat | 6,000 | Slider | C-Track |
| 43565-157-XZ | Standard | X-treme Zinc | 6,000 | Slider | C-Track |
| 43573-10 | Storable | Black Lacquer | 5,500 | Weld-On | Bottom |
| 43579-20 | Low Profile | Black Lacquer | 5,500 | Weld-On | Side Frame |
| 48101-103 | Low Profile | Black E-Coat | 6,000 | Weld-On | Side Frame |
| 48101-143 | Standard | Black E-Coat | 6,000 | Weld-On | Bottom |
| 49207-127 | Storable | Black Powder Coat | 5,500 | Slider | Double L-Track |
| 49207-127-XZ | Storable | X-treme Zinc | 5,500 | Slider | Double L-Track |
| 49207-137 | Standard | Black Powder Coat | 5,500 | Slider | Double L-Track |
| 49207-137-XZ | Standard | X-treme Zinc | 5,500 | Slider | Double L-Track |
| 49207-187 | Low Profile | Black Powder Coat | 5,500 | Slider | Double L-Track |
| 49207-187-XZ | Low Profile | X-treme Zinc | 5,500 | Slider | Double L-Track |
| 49207-273 | Standard | Black Powder Coat | 5,500 | Slider | Double L-Track |
| 49207-273-XZ | Standard | X-treme Zinc | 5,500 | Slider | Double L-Track |
| 49207-283-XZ | Low Profile | X-treme Zinc | 5,500 | Slider | Double L-Track |
| 49706-10 | Standard | Black Powder Coat | 5,500 | Slider | Wilson Track |

Cable



43488-20
• Low Profile
• Side Mount

DID YOU KNOW?

3-Bar: Designed for easy strap insertion during snow & ice conditions. Prevents mandrel from freezing up.

Double Cap: Incremental adjustment from both sides of the winch allows for clearance applications.

Sliders: Allow for easy positioning on the truck, and lock into place when tension is applied to the strap.

Weld-On



43563-10
• Standard
• Bottom Mount



48101-143
• 3-Bar Standard
• Bottom Mount



43573-10
• Storable
• Bottom Mount



48101-103
• 3-Bar Low Profile
• Side Mount
• Extended Pawl



43579-20
• Low Profile
• Side Mount

Portable / Bolt-On



43564-147
• Standard



43564-127
• Storable



43564-167
• Low Profile

CAUTION: 7MM Winches should not be welded due to welding affect on the strength provided by the heat treating process.

Avoid welding zinc treated parts due to toxic fumes.

FLAT BED SOLUTIONS

C-Track Sliders



7MM
43565-157
• Standard



7MM
43565-127
• Storable



7MM
43565-14
• Storable
• Side Washers



7MM
43565-137
• Standard
• Double Cap



7MM
XZ
43565-157-XZ
• Standard



7MM
XZ
43565-127-XZ
• Storable

L-Track Sliders



7MM
49207-137
• Standard
• Extended Pawl



7MM
49207-273
• 3-Bar Standard



7MM
49207-187
• Low Profile



7MM
49207-127
• Storable



7MM
XZ
49207-187-XZ
• Low Profile



7MM
XZ
49207-127-XZ
• Storable



7MM
XZ
49207-137-XZ
• Standard



7MM
XZ
49207-273-XZ
• 3-Bar Standard



7MM
XZ
49207-283-XZ
• 3-Bar Low Profile

Wilson Track Sliders



49706-10
• Standard

X-TREME *ZINC*TM

- *X-Treme Zinc Coated*
- *Better Corrosion Protection*
- *Longer Lasting*

Black powder coat is the standard finish for most winches.

Smooth ground web slots prevent web wear.

Seamless solid steel mandrel.



Powder coating withstands 250 hours of standard salt spray testing to ensure years of service.

Stamped working load limit & Ankra name certify quality.

High-strength alloy pawl pins.

FLAT BED SOLUTIONS

Ratcheting Winches

Faster and more convenient than traditional winches. Reduces the tensioning time by 33%. Also, reduces risk of winch bar rollover. Once the winch bar tip is inserted into the winch cap, the winch can be fully tensioned without the need to repetitively remove and reposition the winch bar.

| Part Number | Winch Type | Surface Treatment | Working Load Limit (lbs) | Attachment | Mount Placement |
|--------------|-------------|-------------------|--------------------------|------------|-----------------|
| 43563-10-RW | Standard | Black Lacquer | 5,500 | Weld-On | Bottom |
| 43565-127-RW | Storable | Powder Coat | 6,000 | Slider | C-Track |
| 43565-157-RW | Storable | Black Lacquer | 6,000 | Slider | C-Track |
| 49207-137-RW | Portable | Powder Coat | 5,500 | Slider | L-Track |
| 49207-187-RW | Low Profile | Powder Coat | 5,500 | Slider | L-Track |



Watch this Video to Learn More!



43563-10-RW

43565-127-RW

43565-157-RW

49207-137-RW

49207-187-RW

Specialty Winches

- 49716-10 | Porta Winch - Outward Offset
- 49716-11 | Porta Winch - Inward Offset
- 49716-10-RW | Ratcheting Porta Winch - Outward Offset

5,500 lbs WLL (2,500 kg)

- Installs easily without tools
- Fasten straps securely and legally
- Inserts into standard trailer stake pockets

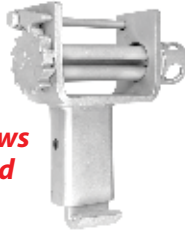

Inward Offset allows for track mounted tarp clearance



FOR STAKE POCKET APPLICATIONS



- 49717-10 | Porta Anchor - Outward Offset

5,500 lbs WLL (2,500 kg)

- Installs easily without tools
- Fasten straps securely and legally
- Inserts into standard trailer stake pockets

- 47640-31 | Lashing Winch

- 3,300 lbs WLL (1,515 kg)
- Double hex drive & 3 mounting holes
- Bolt on/Weld on
- Side frame
- Black lacquer



Perfect for Ladder Racks & Construction Vehicles

- 49723-10 | SilverCap OverDrive®

- 5,500 lbs WLL (2,500 kg)
- Converts standard winches to ratcheting winches
- Works with weld-on, sliding, or portable mount winches
- Reduces time needed to load & unload cargo
- Lowers stress & fatigue on operators

TURN STANDARD WINCHES INTO RATCHETING WINCHES QUICK & EASILY



Winch Track

C-Track



L-Track



| Part Number | Length | Material Type | Attachment Method | Track Type |
|--------------|--------|---------------|-------------------|----------------|
| 42357-11 | 6' | Steel | Weld-On | C-Track |
| 42357-12 | 12' | Steel | Weld-On | C-Track |
| 42357-21 | 6' | Aluminum | Bolt-On | C-Track |
| 49242-10-120 | 10' | Aluminum | Bolt-On | Double L-Track |

FLAT BED SOLUTIONS

Winch Bars

All winch bars are made from heat treated steel for extra strength and designed for use with standard winch caps. Each bar has a knurled handle in two sections for improved grip and a flanged mushroom tip end to keep the bar from slipping within the winch cap.

42313-10 | 34^{IN} Standard Black

- Black powder coat finish



42313-12 | 34^{IN} Combination Box End

- Painted silver & yellow finish
- Chain binder release end



42313-17 | 34^{IN} Standard Chrome

- Chrome finish



42313-19 | 34^{IN} Combination Chrome

- Chrome finish
- Open ended



Goose Neck design reduces the number of times the operator needs to remove & replace the bar to tighten the strap. Also allows operator to keep the bar in a safer more ergonomic position to prevent back injuries & injuries caused by bar slippage from winch cap.

50015-10 | 34^{IN} ERGO 360° Standard



50015-20 | 34^{IN} ERGO 360° Combination

- Open ended



50015-21 | 34^{IN} ERGO 360° Combination Box End

- Chain binder release end



Accessories

49344-12 | Coil Rack

- Heavy duty
- 14" Steel sheet per ASTM A36
- Black lacquer finish



49345-10 | Floor Chain Tie-Down

- Weld-on
- 3/8" G70 transport chain
- Black E-coat
- 6,000 lbs WLL

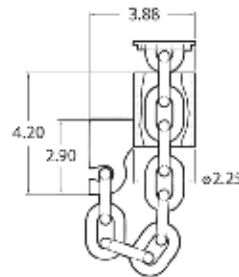

49583-10 | Floor Chain Tie-Down

- Bolt-on
- 3/8" G70 transport chain
- Zinc plated
- 6,000 lbs WLL

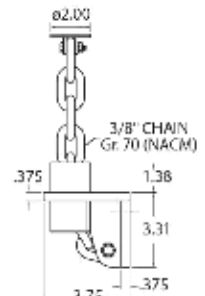

50105-11 | Poly Deckboard

- 48" x 48" x 2.7" Thick
- For beams set at 16" & 24" spacing
- Lighter than plywood
- Eliminates clean up, disposal & safety issues associated with wood splinters
- Ergonomic
- Stackable



49527-10 | GlideLock®

5,400 lbs WLL (2,450 kg)

- Moveable securement bracket for double L-track
- Provides a sliding positive attachment point for flat hooks



INTERIOR VAN SOLUTIONS

Logistic Straps for E & A Track

Ratchet Buckle | Spring End Fitting

1,333 lbs WLL (605 kg)

- 48" Fixed end
- Low profile ratchet
- Bulk packaged
- Color coded by length

| Part Number | Length (Feet) | Color |
|-------------|---------------|--------|
| 48672-13 | 12' | Yellow |
| 48672-14 | 16' | Gray |
| 48672-15 | 20' | Blue |

2" Standard High Capacity Webbing



Cam Buckle | Spring End Fitting

833 lbs WLL (378 kg)

- 48" Fixed end
- Bulk packaged
- Color coded by length

| Part Number | Length (Feet) | Color |
|-------------|---------------|--------|
| 40602-17 | 12' | Yellow |
| 40602-18 | 16' | Gray |
| 40602-19 | 20' | Blue |

2" Standard High Capacity Webbing



Logistic Track

Series E-Track

- Available in horizontal & vertical styles
- Designed to be screwed or bolted to floors, sidewalls or wood studs
- Provides convenient anchoring slots to secure cargo with Ancra logistic straps or create decking tiers with Ancra decking & shoring beams
- Made with 12-gauge steel
- Finished with a high quality powder coat, semi-gloss enamel or G90 hot dip galvanize for exceptional corrosion resistance

Horizontal



Gray Powder Coat
10FT **48117-25-120.00**
5FT **48117-25-60.00**



Black Powder Coat
10FT **48117-32-120.00**



Galvanized
10FT **48117-21-120.00**
5FT **48117-21-60.00**

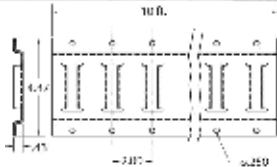

Vertical

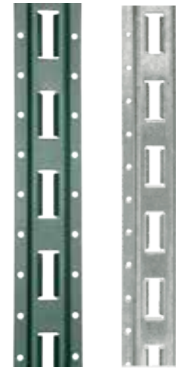

10FT Gray Powder Coat **40838-10**
10FT Galvanized **40838-11**

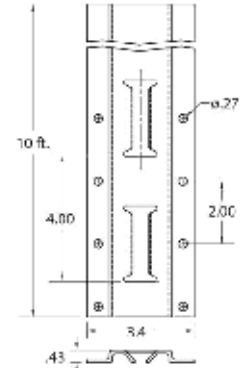

Aircraft Style Aluminum O-Track

- Available in standard & beveled styles
- Designed to be screwed or bolted to floors, sidewalls or wood studs
- Works with single or double stud fittings
- Beveled style helps prevent catch point for cargo & footing
- Easy to remove debris from track with air hose

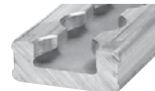

6FT Standard Profile **40467-33-72.00**



6FT Beveled Profile **50193-30-72.00**

Decking & Shoring Beams for E & A Track

- Light weight aluminum helps maximize payload & resists corrosion
- Adjustable ranges available to fit most commercial trailer widths
- Designed to create decks to hold pallets or to prevent pallets from shifting
- Ancra patented flat latch eliminates damaged triggers & is easier to release, even when wearing gloves

| Part Number | Adjustable Range | Style | Decking WLL (lbs) | Shoring WLL (lbs) |
|-------------|------------------|------------|-------------------|-------------------|
| 43638-50 | 84.7" - 95.6" | Standard | 2,200 | 2,200 |
| 43638-51 | 92.9" - 103.8" | Standard | 2,200 | 2,200 |
| 49039-50 | 84.7" - 95.6" | Heavy Duty | 3,000 | 2,500 |
| 49039-51 | 92.9" - 103.8" | Heavy Duty | 3,000 | 2,500 |
| 49039-52 | 96" - 106.9" | Heavy Duty | 3,000 | 2,500 |

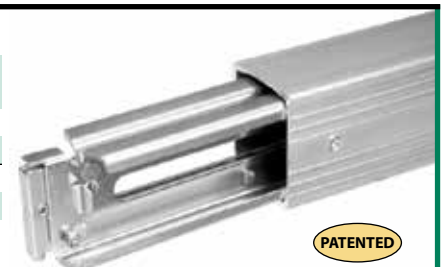

PATENTED

INTERIOR VAN SOLUTIONS

Adjustable Cargo & Jack Bars

43782-15 | Cargo STA®, Aluminum

89.75^{IN} - 104.5^{IN}

- Pressure fit from wall to wall to help prevent cargo shift
- 4" x 4" Foot pads
- 8.95 Lbs



48407-10 | Cargo STA®, Galvanized Steel

89.75^{IN} - 104.5^{IN}

- 2" x 4" Foot pads
- 11.72 Lbs



49205-25 | Jack Bar, Galvanized Steel

85.00^{IN} - 104.00^{IN}

- Pressure fit from floor to ceiling to prevent cargo shift
- 4" x 4" Foot pads
- Quick release jack mechanism
- 16.2 Lbs

PATENTED



CAUTION: Due to variations in the trailer wall construction cargo bars do not have a working load limit.

Driver Assist Products

Driver Assist Straps | **10902-11PK** | Single Loop

| **10902-21** | Dual Loop

- 36" Strap with a reinforced 12" loop handle
- Connects to E & A-track



10924-10 | Trailer Door Limit Strap

800 lbs WLL (363 kg)

- Hooks are inserted into the lock tabs on each door before opening to limit the motion of the door
- 32" Length from hook to hook



10788-10 | Door Pull Strap Kit

500 lbs WLL (227 kg)

- Allows driver to close the roll-up door while standing on the ground
- Black wear sleeve protects the elastic section
- Installs into logistic post or E-track



50354-10 | Fifth Wheel Release

- 35" Length
- Chrome plated finish
- Welded steel construction



Door Pull Straps

- Galvanized steel clip
- Designed for pulling overhead & side doors



| Part Number | Length (Inches) |
|-------------|-----------------|
| 49015-18 | 18" |
| 49015-24 | 24" |
| 49015-36 | 36" |

TRACK FITTINGS & ANCHORS

Hardware - Bulk Bin Packaged

XH8003-12PB | 12/Box
 12" O-Track - Beveled
 1,333 lbs WLL (600 kg)
 • Great for floor mounting



XH8005-12PB | 12/Box
 Single Stud O-Track Fitting
 1,333 lbs WLL (600 kg)
 • Designed for standard
 & beveled logistic track



XH8006-12PB | 12/Box
 Double Stud O-Track Fitting
 2,000 lbs WLL (909 kg)
 • Designed for standard
 & beveled logistic track



XH8022-12PB | 12/Box
 HD E-Track Fitting w/O-Ring
 2,000 lbs WLL (909 kg)
 • Makes E-track useable with standard
 tie-down hooks
 • Low profile



XH8031-8PB | 8/Box
 5/8" D-Ring
 5,000 lbs WLL (2,267 kg)
 • Forged steel ring with bracket
 • Surface mount weld-on design



XH8030-8PB | 8/Box
 3/4" D-Ring
 6,666 lbs WLL (3,023 kg)
 • Forged steel ring with bracket
 • Surface mount weld-on design



D-Rings

49896-10
 1/2" D-Ring
 4,000 lbs WLL (1,814 kg)
 • Forged steel ring with
 bolt-on clip



49896-11
 1/2" D-Ring
 4,000 lbs WLL (1,814 kg)
 • Forged steel ring with bracket
 • Surface mount weld-on design



49897-10
 5/8" D-Ring
 6,300 lbs WLL (2,858 kg)
 • Forged steel ring with bracket
 • Surface mount weld-on design



49898-10
 3/4" D-Ring
 9,000 lbs WLL (4,082 kg)
 • Forged steel ring with bracket
 • Surface mount weld-on design



49899-10
 1" D-Ring
 15,600 lbs WLL (7,076 kg)
 • Forged steel ring with bracket
 • Surface mount weld-on design



49899-11
 1" Bent D-Ring
 15,600 lbs WLL (7,076 kg)
 • Forged bent steel ring with bracket
 • Surface mount weld-on design



TRACK FITTINGS & ANCHORS

E-Track Tie-Off Fittings - Bulk

47772-12

2^{IN} HD E-Track Fitting w/O-Ring
1,833 lbs WLL (833 kg)

- Makes E-track useable with standard tie-down hooks
- Low profile



50115-10

HD E-Track Fitting w/O-Ring
2,000 lbs WLL (909 kg)

- Makes E-track useable with standard tie-down hooks
- Low profile



50115-11

HD E-Track Fitting w/D-Ring
2,000 lbs WLL (909 kg)

- Makes E-track useable with standard tie-down hooks
- Low profile



40386-11

5" Rope Tie Off Strap
1,000 lbs WLL (454 kg)

- Spring acuated fitting

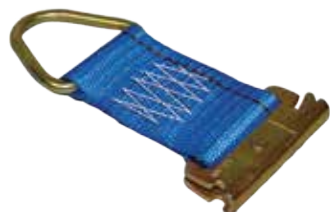

41409-13

2^{IN} 3 Piece Fitting
1,000 lbs WLL (454 kg)

- Replacement end for 2" web straps



47608-21

Series E & A Track Spring Fitting

- Replacement end for 2" web straps
- 1,333 lbs WLL in 12 gauge track
- 1,500 lbs WLL in 11 gauge track



O-Track Tie-Off Fittings - Bulk

50112-10

Single Stud O-Track Fitting
1,333 lbs WLL (600 kg)

- Aluminum retainer
- Blue



50112-20

Single Stud O-Track Fitting
1,333 lbs WLL (600 kg)

- Cast retainer
- Blue



50362-11

Double Stud O-Track Fitting
1,666 lbs WLL (756 kg)

- Designed for standard & beveled logistic track



Pan Tie-Off Fittings

45545-15

Pan Fitting
530 lbs WLL (240 kg)

- Galvanized steel
- Low profile surface mount, bolt-on



45849-15

Recessed Pan Fitting
1,666 lbs WLL (757 kg)

- Low profile, recessed mount, bolt-on



40921-10 | Standard Beam Socket

Make your own shoring beam. For use with standard commercial grade 2" x 6" structural lumber.

PLEASE NOTE: The working load limit of lumber varies widely.



CHAIN FITTINGS

Screw Pin Shackles

Galvanized

- Screw pin style
- Individually polybagged with UPC
- Retail pack quantity 1

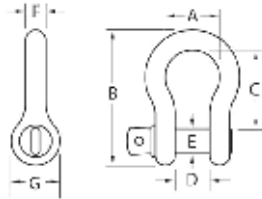

| Part Number | Size (Inches) | Working Load Limit (lbs) | Working Load Limit (kg) |
|-------------|---------------|--------------------------|-------------------------|
| 50013-31 | 5/16" | 1,500 | 681 |
| 50013-38 | 3/8" | 2,000 | 900 |
| 50013-44 | 7/16" | 3,000 | 1,362 |
| 50013-50 | 1/2" | 4,000 | 1,816 |
| 50013-63 | 5/8" | 6,500 | 2,951 |
| 50013-75 | 3/4" | 9,500 | 4,313 |
| 50013-88 | 7/8" | 11,300 | 5,125 |
| 50013-100 | 1" | 17,000 | 7,710 |

| Dimensions | A | B | C | D | E | F | G |
|------------|----------|------|------|------|------|-----|------|
| | 50013-31 | .81 | 2.25 | 1.25 | .53 | 3/8 | .31 |
| 50013-38 | .94 | 2.61 | 1.44 | .66 | 7/6 | .38 | 1.13 |
| 50013-44 | 1.06 | 3.01 | 1.69 | .72 | 1/2 | .44 | 1.25 |
| 50013-50 | 1.19 | 3.34 | 1.88 | .81 | 5/8 | .50 | 1.38 |
| 50013-63 | 1.50 | 4.04 | 2.41 | 1.06 | 3/4 | .63 | 1.88 |
| 50013-75 | 1.75 | 5.04 | 2.84 | 1.25 | 7/8 | .75 | 2.13 |
| 50013-88 | 2.00 | 5.86 | 3.31 | 1.44 | 1.00 | .75 | 2.38 |
| 50013-100 | 2.31 | 6.63 | 3.75 | 1.69 | 1.13 | .75 | 2.63 |

Clevis Pin Shackles

Galvanized

- Clevis pin style
- Individually polybagged with UPC
- Retail pack quantity 1

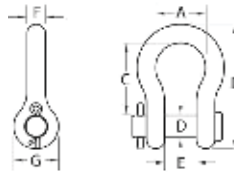

| Part Number | Size (Inches) | Working Load Limit (lbs) | Working Load Limit (kg) |
|-------------|---------------|--------------------------|-------------------------|
| 50014-50 | 1/2" | 4,000 | 1,816 |
| 50014-63 | 5/8" | 6,500 | 2,951 |

| Dimensions | A | B | C | D | E | F | G |
|------------|----------|------|------|------|------|-----|------|
| | 50014-50 | 1.19 | 3.39 | 1.88 | 5/8 | .81 | .50 |
| 50014-63 | 1.50 | 4.17 | 2.41 | 3/4 | 1.06 | .63 | 1.88 |

Clevis Pin Replacements

High strength steel replacement clevis pins are designed to meet the strength requirements of Grade 70 hooks & their heads are marked G7 or 70.

50412-100 Packaged Kit includes one zinc plated clevis pin & cotter pin for 5/16 Grade 70 chain hook. Weight: .17 lbs / .07 kg

50412-102 Packaged Kit includes one zinc plated clevis pin & cotter pin for 3/8 Grade 70 chain hook. Weight: .22 lbs / .09 kg

50412-103 Packaged Kit includes one zinc plated clevis pin & cotter pin for 1/2 Grade 70 chain hook. Weight: .23 lbs / .10 kg

Note: Ancra does not offer galvanized replacement pins. Zinc-plated steel replacement pins can be used with galvanized steel clevis hooks without concern for bimetallic corrosion. However, the sacrificial zinc plated layer may wear slightly faster than the galvanized layer.

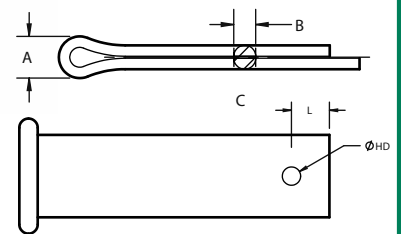

Quick Links

Zinc Plated Clear Chromate

- Individually polybagged with UPC
- Retail pack quantity 1

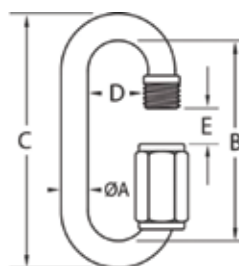

| Part Number | Size (Inches) | Working Load Limit (lbs) | Working Load Limit (kg) |
|-------------|---------------|--------------------------|-------------------------|
| 50016-25 | 1/4" | 880 | 399 |
| 50016-31 | 5/16" | 1,760 | 799 |
| 50016-38 | 3/8" | 2,200 | 998 |

| Dimensions | A | B | C | D | E |
|------------|----------|------|------|------|-----|
| | 50016-25 | .235 | 1.85 | 2.31 | .51 |
| 50016-31 | .313 | 2.32 | 2.95 | .65 | .41 |
| 50016-38 | .350 | 2.54 | 3.22 | .67 | .43 |